

OXWORKS®

STANDARD PANELS

2400 x 1200mm Panel - Powdercoated
38 x 25mm x 1.6mm RHS
16mm CHS (1.2mm) Vertical Tubes
16 x 3mm Flat Cross
Pattern may vary

FIXINGS

38 x 25mm Horizontal Fence Brackets
2 Hole - Single Lugged
3 x 12-14*20 Self Tapping Tek Screws
used per Fence Bracket

STANDARD GATES

970 x 1200mm Gate - Powdercoated
38 x 25mm Frame (Non-Mitred)

ALUMINIUM POSTS

50 x 1800 x 1.6mm In Ground Post
50 x 2100 x 1.6mm In Ground Post
50 x 1300 x 1.6mm Flanged Post
50 x 1600 x 1.6mm Flanged Post

- **In Ground Post**
200 x 500/600mm Post Hole
Hole filled with Post Mix Concrete
- **Core Drilled Post**
Minimum 75mm x 100mm Core Drill
Hole filled with MP60 Non-Shrink Bostik Grout
- **Flanged Post - On Slab**
M10 x 75mm Galvanised Dyna Bolt
- **Flanged Post - On Timber**
14 x 75mm Hex Head Batten Screw
into Structural timber

MATERIALS

6063 T6 Aluminium - Powder Coated

All of our Garden Fencing styles are available in the Interpon Powder Coating Colour Range

NB: All measurements have a manufacturing tolerance of +/- 2mm

TITLE: **ALUMINIUM GARDEN FENCING DAINTEE**

CONTACT: sales@oxworks.com.au

oxworks.com.au 1300 336 237



HIGHER CUSTOM PANELS - Custom panels 1500mm High and above will have an extra rail **1200mm down from the top** of the panel. If you require the extra rail positioned elsewhere, please let our sales staff know at the time of quoting.

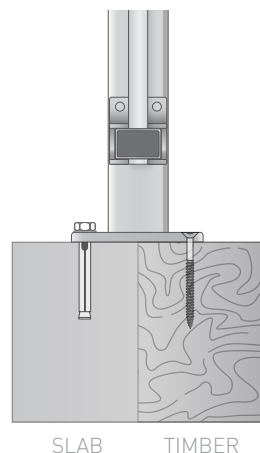
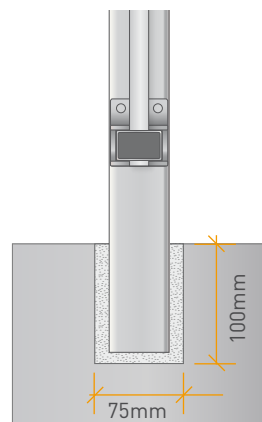
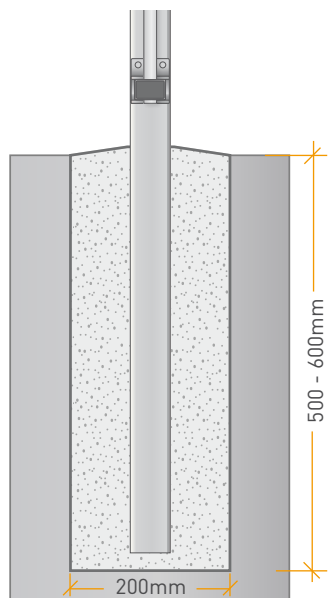

WELDED BASE PLATE
100 x 100mm
11mm HOLES
REFER TO NOTES

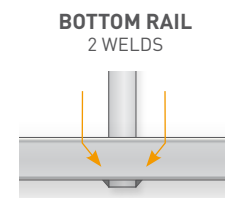
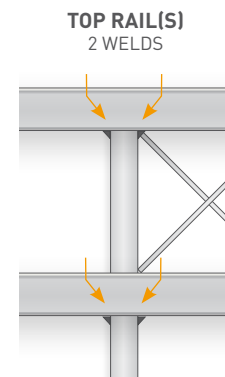
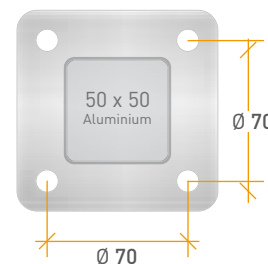

WELD DETAILS